

CM1.00 & CM1.25 Certification Masters**Description:**

The CM1.00 and CM1.25 Certification Masters are used to check and certify the accuracy of the TruPosition Probes. If you have a calibration system and want to maintain files on your TruPosition Probes, then the CM1.00 and CM1.25 Certification Masters are the best and quickest way to check calibration.

CM1.00

The TruPosition Probe must:

1. be set to zero using the Zero Master.
2. be inserted into the Certification Master.
3. be rotated in the Master until the "A" axis reads "0.00." the "B" axis should read ".50 +/- .01mm
4. be rotated in the Master until the "B" axis reads "0.00." the "A" axis should read ".50 +/- .01mm

Note:

Readings are to be taken at all four quadrants(+A, -A, +B, and -B).

The CM1.00 Certification Master checks TruPosition Probes with 1.00" dia shafts.

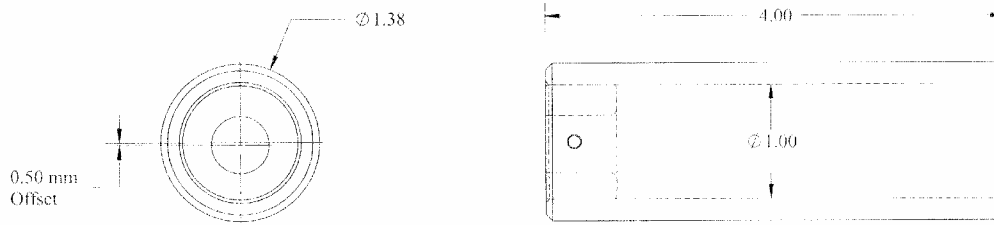
**CM1.25**

The TruPosition Probe must:

1. be set to zero using the Zero Master.
2. be inserted into the Certification Master.
3. be rotated in the Master until the "A" axis reads "0.00." the "B" axis should read "1.00 +/- .01mm
4. be rotated in the Master until the "B" axis reads "0.00." the "A" axis should read "1.00 +/- .01mm

Note:

Readings are taken at all four quadrants (+A, -A, +B, and -B).

The CM1.25 Certification Master checks TruPosition Probes with 1.25" Dia. shafts.

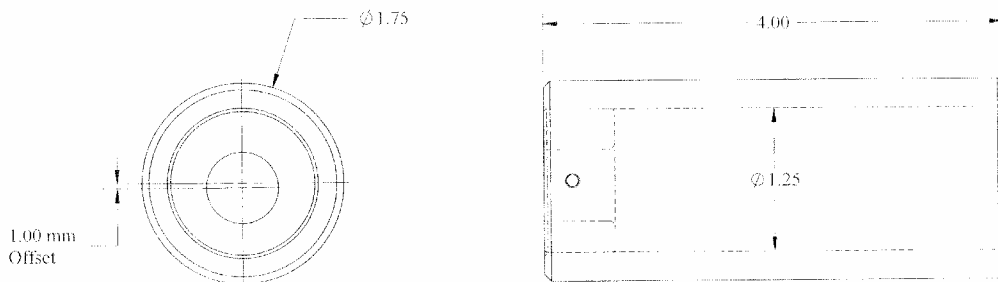
**Both Models Shipped with:**

NIST traceable certification documents.